

Inline Fuse Holders for Blade-Type Fuses

HHC, HHD, HHF, HHG, HHR and HHS (For ATC® Fuse)

Inline Fuse Holders for ATC® Blade-Type Fuses

Rating: 32V, See table for max. amp.

"Write-in" space for circuit identification on HHC holder.

Plastic cover fits only HHD holder. HHR holder has a locking cover and mounting hole. HHS is a self-stripping holder.



Dimensions - in

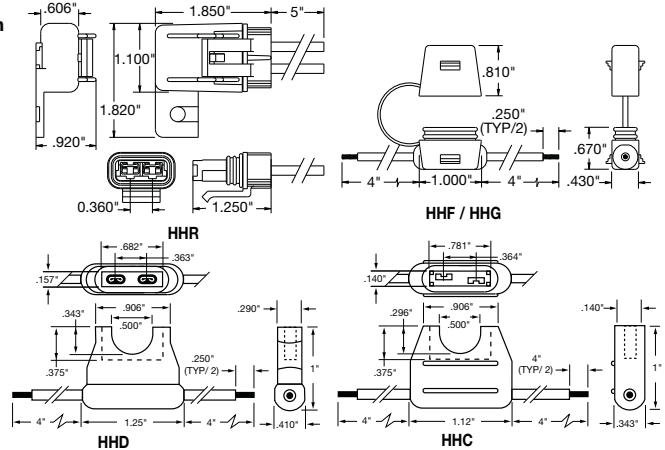

Multiply by 25.4 for metric. (Dims. Shown are for reference only. Contact factory for latest prints)

ATC® Blade Type Holder

Catalog No.	Description	Fuse Size	Electrical Connection
HHC	Yellow fuseholder (body only)	1-20A	# 18 AWG lead black wire
HHD	Black fuseholder (body only)	1-30A	# 12 AWG lead yellow wire
HHD-C	Cover only	Fits only HHD	Clear polycarbonate
HHF	Black fuseholder w/cover	1-20A	# 16 AWG lead yellow wire
HHG	Black fuseholder w/cover	1-30A	# 12 AWG lead yellow wire
HHR	Flack waterproof fuseholder w/locking cover & mounting hole	1-30A	# 12 AWG lead orange wire 5" length
HHS	Blue Fuse holder	1-20A	Self-stripping; accepts #18-#14 AWG copper wire only

HHL and HHM (For ATM Fuse)

In-Line Fuseholders for ATM MINI® Fuses.

Rating: 32V, See table for max. amp.

Body material withstands high temps. Protective cover has removable straps.



Dimensions - in

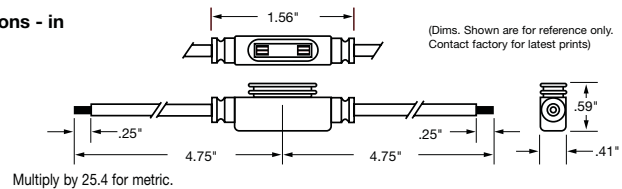

Multiply by 25.4 for metric.

MINI Fuse Blade Type Holder

Catalog No.	Description	Fuse Size	Electrical Connection
HHL	Fuseholder w/cover	2-20A	# 16 AWG lead black wire; 4" length
HHL-B	Body only		
HHM	Fuseholder w/cover	2-30A	# 12 AWG lead red wire; 4" length
HHM-B	Body only		
HHM-C	Cover only		

HHX (For MAXI® Fuse)

In-Line Fuseholder for MAXI™ Fuses.

Rating: 32V, 60A Max. Firewall mounting hole

permits two or more holders to be mounted together. Cover comes with a removable strap.



Dimensions - in

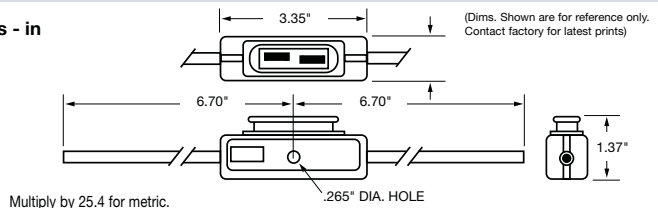

Multiply by 25.4 for metric.

MAXI® Fuse Blade Type Holder

Catalog No.	Description	Fuse Size	Electrical Connection
HHX	Fuseholder w/cover	20-60 amps	#6 lead wire; 5" length
HHX-B	Body only		
HHX-C	Cover only		